

Rain Garden Planting				Planted in single species block as directed on site evenly spaced throughout area into prepared rain garden medium.																												
Code	Species	Size	Spec	Form	Notes	BED	RG15	RG16	RG17	RG18	RG19	RG20	RG21	RG22	RG23	RG24	RG25	RG26	RG27	RG28	RG29	RG30	RG31									
Ah	Aster herbivyl	300-450mm	P9/11tr	Ctr		8	4.2	6.5	8	4	2	2.3	4.5	4.9	6.2	4	3.5	6	8	8.5	5	4.5	5.5									
Am	Alchemilla mollis	300-450mm	P9/11tr	Ctr		6			6				12		6																	
Cg	Campylopus glomerata	300-450mm	P9/11tr	Ctr					24		8	8			16	24			32			16										
Gr	Geranium Rozanne 'Gerwat'	300-450mm	P9/11tr	Ctr		8	10															24	16									
GJ	Geranium Jacksons Blue	300-450mm	P9/11tr	Ctr		8				24												24	16									
MS	Mianthus Sibiricus Sibirspine	450-600mm	2tr	Ctr		3	3			3	3			3	3	3																
Vb	Verbena bonariensis	450-600mm	1tr	Ctr		3	3							3	3																	
Vm	Vinca minor	300-450mm	P9/11tr	Ctr	Cut back to 300mm	6		18										16	12	24	12		6	12								
Vor	Viburnum opulus Compactum	450-600mm	2tr	Ctr		5		15										5	5	5	20	10	8	4								

Native tree and shrub planting - Mix NH1	Height	Form	Size	%mix	Spacing	Notes
Species						
Corylus avellana	450-600mm	Br	2+0	30	0.8/m ²	Min 3 breaks
Crataegus monogyna	450-600mm	Br	2+0	30	0.8/m ²	Min 3 breaks
Prunus cerasifera	450-600mm	Br	2+0	5	0.8/m ²	
Rosa carolina	450-600mm	Br	1+1	15	0.8/m ²	Min 3 breaks
Sorbus aria	450-600mm	Br	2+0	5	0.8/m ²	
Sambucus nigra	450-600mm	Br	1+1	10	0.8/m ²	Min 3 breaks
Sorbus aucuparia	450-600mm	Br	2+0	5	0.8/m ²	

Planting to be a 1.5m centres into prepared pits in staggered rows max. no in groups of the same species to be 7. Pits to be 300x300x300mm backfilled with topsoil and 100mm organic matter + Microbial granules + Slow release fertiliser at manufacturers recommended rates

MIX A Emorsgate - EG22 Basic Strong Lawn Grass Mix (Amenity Mix)		
Grasses	Latin name	Common name
5	Agrostis capillaris	Common Bent
20	Lolium perenne	Perennial Ryegrass
50	Festuca rubra	Red Fescue
20	Poa pratensis	Smooth-stalked Meadow-grass
100		
	Sowing Rates	Sowing Rates
	kg/ha	g/m ²
	200	25

All seedlings to be sown in April/May or late August/September into prepared soil, sown to a depth of 10-15mm with an application of pre-seeding fertiliser applied before sowing and in accordance with the manufacturer's recommendations. Any failed areas to be made good. If turf is used instead of seed it will comprise an Amenity Mix as above to be approved.

MIX B EM1 Basic General Purpose Meadow Mixture		
Wildflowers	Latin name	Common name
1	Achillea millefolium	Yarrow
0.5	Betonica officinalis - (Stachys officinalis)	Betonny
2.5	Centaurea nigra	Common Staggweed
2.5	Daucus carota	Wild Carrot
2	Galium album - (Galium mollugo)	Hedge Bedstraw
1	Galium verum	Lady's Bedstraw
3	Leucanthemum vulgare	Oxeye Daisy - (Moon Daisy)
6.8	Malva moschata	Musk Mallow
0.1	Plantago lanceolata	Ribwort Plantain
0.1	Potentilla sanguisorba - (Sanguisorba minor)	Salad Burnet
0.1	Ranunculus acris	Meadow Buttercup
0.1	Rhinanthus minor	Yellow Rattle
0.2	Stivex latifolia	White Campion
20		
Grasses	Latin name	Common name
8	Agrostis capillaris	Common Bent
28	Cynosurus cristatus	Crested Dogstail
24	Festuca rubra	Red Fescue
4	Phleum pratense	Smaller Cat's-tail
16	Poa pratensis	Smooth-stalked Meadow-grass
80		
	Sowing Rates	Sowing Rates
	kg/ha	g/m ²
	10	1

KEY

Existing vegetation (to remain):

- Existing Native Vegetation to remain
- Existing vegetation to be removed

Proposed Planting and Seeding:

- Proposed Native Tree and Shrub Planting NHM1
- Proposed Native Hedge Planting NH1
- Low Shrub/Groundcover Planting Bed Refer to schedule for species
- Lawn/Amenity / short mown grassland = Mix A
- Species Rich Grassland = Mix B
- Species Rich Grassland = Mix C
- Proposed climber (species as indicated)
- Proposed Raingarden (species as indicated)

INDIVIDUAL SPECIMEN TREE PLANTING

- Proposed Rootball/Container grown Conifer refer to schedule for numbers and planting details
- Proposed Specimen Tree species as indicated - see schedule for sizes

Scrubland and tree extents along this retained for ecological benefit habitat. Exact extent and Locations to be wing receipt of remaining Topographical area. Seeding will reflect reinstatement known

2No. RED SQUIRREL BOXES IN EXISTING TREES

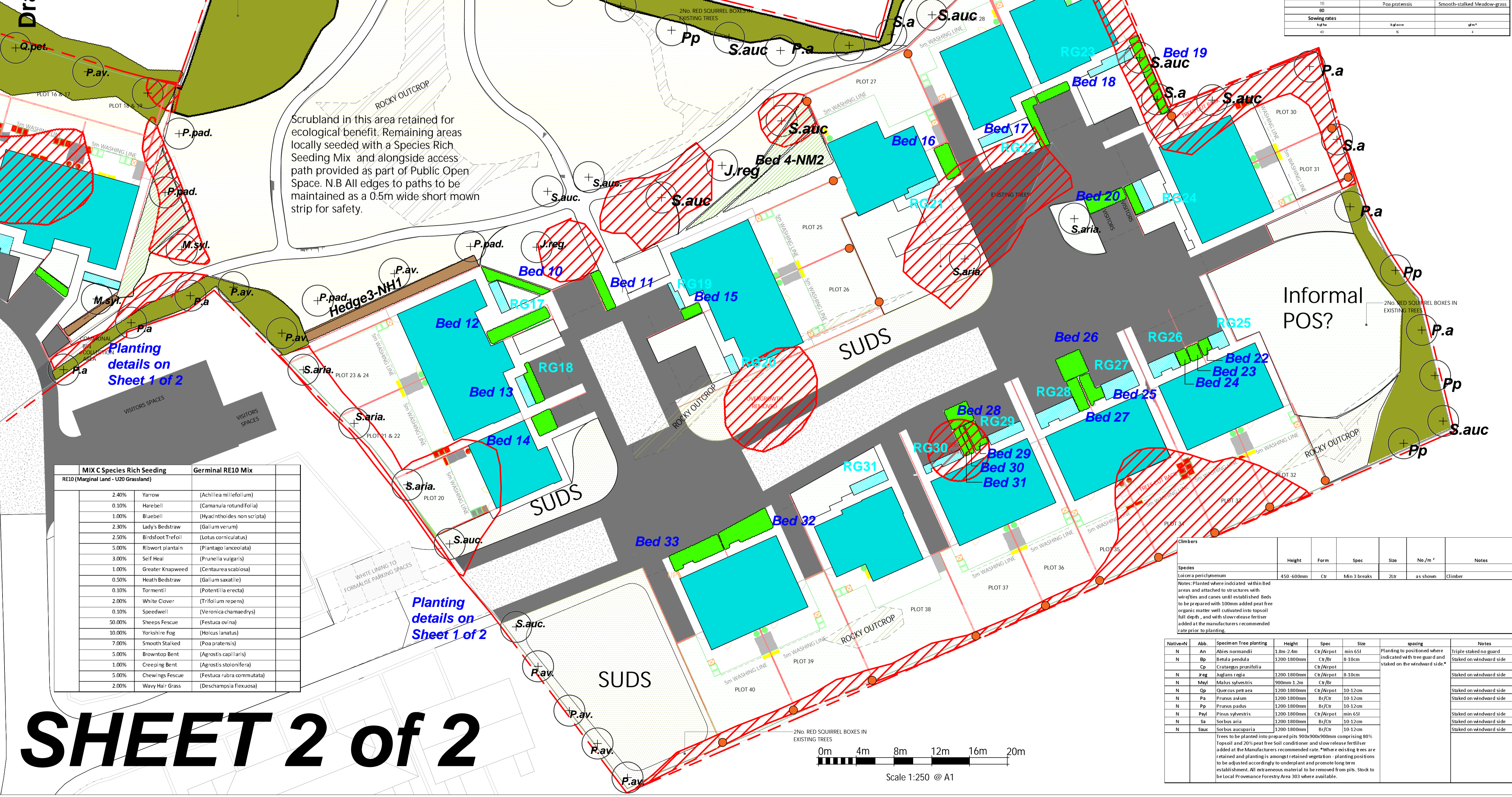

Scrubland in this area retained for ecological benefit. Remaining areas locally seeded with a Species Rich Seeding Mix and alongside access path provided as part of Public Open Space. N.B All edges to paths to be maintained as a 0.5m wide short mown strip for safety.

Planting details on Sheet 1 of 2

Planting details on Sheet 1 of 2

MIX C Species Rich Seeding		Germinal RE10 Mix	
RE10 (Marginal Land - U20 Grassland)			
2.40%	Yarrow	(Achillea millefolium)	
0.10%	Harebell	(Campanula rotundifolia)	
1.00%	Bluebell	(Hyacinthoides non-scripta)	
2.30%	Lady's Bedstraw	(Galium verum)	
2.50%	Birdfoot Trefoil	(Lotus corniculatus)	
5.00%	Ribwort plantain	(Plantago lanceolata)	
3.00%	Self Heal	(Prunella vulgaris)	
1.00%	Greater Knapweed	(Centaurea scabiosa)	
0.50%	Heath Bedstraw	(Galium saxatile)	
0.10%	Tormentil	(Potentilla erecta)	
2.00%	White Clover	(Trifolium repens)	
0.10%	Speedwell	(Veronica chamaedrys)	
50.00%	Sheeps Fescue	(Festuca ovina)	
10.00%	Yorkshire Fog	(Holcus lanatus)	
7.00%	Smooth Stalked	(Poa pratensis)	
5.00%	Browntop Bent	(Agrostis capillaris)	
1.00%	Creeping Bent	(Agrostis stolonifera)	
5.00%	Chewings Fescue	(Festuca rubra commutata)	
2.00%	Wavy Hair Grass	(Deschampsia flexuosa)	

Species	Height	Form	Spec	Size	No./m ²	Notes
Loxera periclymenum	450-600mm	Ctr	Min 3 breaks	2tr	as shown	Climber

Native	Abb.	Specimen Tree planting	Height	Spec	Size	spacing	Notes
N	An	Abies normandii	1.8m-2.6m	Ct/Nr/pt	min 65l		Triple staked no guard
N	Bp	Betula pendula	1200-1800mm	Ct/Nr/pt	Ø 10cm		Staked on windward side
N	Cp	Crataegus granulata		Ct/Nr/pt			Staked on windward side
N	Jreg	Juglans regia	1200-1800mm	Ct/Nr/pt	Ø 10cm		Staked on windward side
N	Myl	Malus sylvestris	900mm-1.2m	Ct/Nr			Staked on windward side
N	Op	Quercus petraea	1200-1800mm	Ct/Nr/pt	Ø 10-12cm		Staked on windward side
N	Pa	Prunus avium	1200-1800mm	Br/Ct	Ø 10-12cm		Staked on windward side
N	Pp	Prunus padus	1200-1800mm	Br/Ct	Ø 10-12cm		Staked on windward side
N	Pyf	Pinus sylvestris	1200-1800mm	Ct/Nr/pt	min 65l		Staked on windward side
N	Sa	Sorbus aria	1200-1800mm	Br/Ct	Ø 10-12cm		Staked on windward side
N	Sauc	Sorbus aucuparia	1200-1800mm	Br/Ct	Ø 10-12cm		Staked on windward side

Trees to be planted into prepared pits 300x300x900mm comprising 80% Topsoil and 20% peat free Soil conditioner and slow release fertiliser added at the Manufacturers recommended rate. *Where existing trees are retained and planting is amongst retained vegetation - planting positions to be adjusted accordingly to understand and promote long term establishment. All extraneous material to be removed from pits. Stock to be local Provenance Forestry Area 303 where available.

N.B All fencing to have Hedgehog access holes and signage to create Hedgehog Highways where indicated. Refer to Ecological reporting provided separately for specific locations and details.

- NOTES:**
- Proposals based upon SAER Architects Ltd. Drawing reference. Proposed Site Plan Ref: MMA-SAL-A1-ZZ-DR-A-0003 P1139 Rev P5
 - Hard Landscape Proposals provided by others.
 - Drawing prepared for Planning purposes not for tendering.
 - Refer to Ecological and Arboricultural reporting provided under separate cover.

Issued v3	PW	JB	JB	05/11/24
Draft v2	PW	JB	JB	24/10/24
Draft v1	PW	JB	JB	20/10/24
Issue	Drawn	Checked	Approved	Date

Tirlun Barr
Chartered Landscape Architects
Tany-Bethan, Llanedeyri Common, Conwy LL32 8UY
Tel: 01492 450333 www.tirlunbarr.com

Client: **Cyngor Sir Ynys Mon**

Project Title: **New Build Housing at Maes Mona Amwch**

Drawing Title: **Soft Landscape Proposals Sheet 2 of 2**

Drawing Number: **38.22.PP.01.2**

Scale: **1:250**

Issue: **v3 Issued**

